

! WARNING

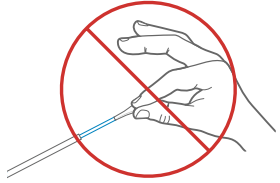

DO NOT touch the tips of the swabs.

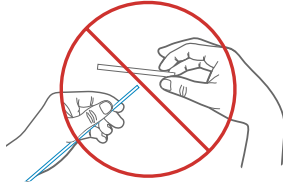

DO NOT remove the plastic straw from the plastic shaft of the swabs.

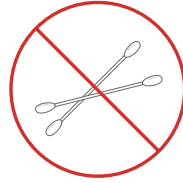

DO NOT use other specimen collection swabs or devices—the test only works with the validated swabs included in this collection kit.

INSTRUCTIONS

Follow these steps to administer the test and get accurate results:

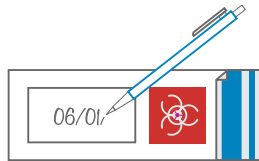

STEP 1:

Complete all of the information on the small clear DryPak envelope.

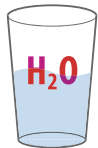

STEP 2:

Rinse the patient's mouth with water.

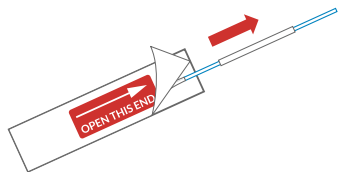

STEP 3:

Remove one swab from its package.

Tear open the package from the bottom and slide out one swab. Hold it by its plastic shaft—**Please DO NOT touch the tip of the cotton swab.**

INSTRUCTIONS (continued)

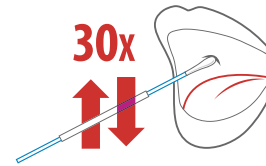

STEP 4:

Ask the patient to open their mouth and place the tip of the cotton swab against the inside of their cheek. Rub the cotton swab back and forth against the inside cheek, about 30 times.

While you rub the cotton swab, turn the plastic shaft. This will ensure the entire tip is covered with cells from the cheek.



STEP 5:

Place the cotton swab into the small clear DryPak envelope.

But don't seal the envelope yet!

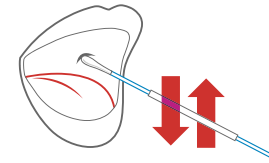

STEP 6:

Remove the second swab from its package. Rub the tip against the inside of the patient's other cheek.

Repeat steps 4 and 5 with the other cheek. Remember, **DO NOT touch the tip** of the swab with your fingers.

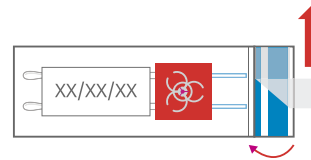

STEP 7:

Place the second swab into the small clear DryPak envelope. Seal the DryPak envelope.

Check to make sure there are now 2 swabs in the small clear DryPak envelope. **DO NOT** place the gel pack or anything else in the DryPak. Seal the small clear envelope by taking off the protective strip. Push the flap down and press firmly.

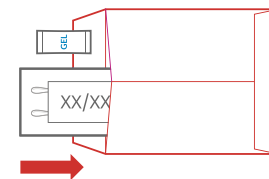

STEP 8:

Put the desiccant package, clear DryPak envelope, and completed test requisition form into the large, clear Ziploc bag.

Before you seal it, make sure only the 2 swabs are sealed inside the small clear envelope. Don't forget the gel pack—it will protect the sample from moisture.

Complete the checklist on the outside of the Ziploc bag. Seal the Ziploc bag and follow instructions for sending the sample back to the testing laboratory.